



COLORADO

Department of Public
Health & Environment

Dedicated to protecting and improving the health and environment of the people of Colorado

COR080000 Renewal Permittees Annual Report Form

Municipal Separate Storm Sewer Systems (MS4s) General Permits **Revised 10/2017**

Part 1: Permit Identification

General Permit Number: **COR080000**

Certification Number: COR08 0011

Part B: Reporting Period Jan 1 through Dec 31

(Check one. Report is due by March 10 of the following year.)

2017 2018 2019 2020 2021

Part 2: Permittee Information (If there are any changes, please submit a [Change of Contacts form](#))

Organization: Town of Parker

Mailing Address: 20120 East Mainstreet

City: Parker State: CO Zip: 80138

Part 3: Site Contact Information (If there are any changes, please submit a [Change of Contacts form](#))

Facility Contact Name: Michael Grabczyk, P.E., CFM

Title: Project Manager

Telephone No: 303.805.3209

Email Address: mgrabczyk@parkeronline.org

Part 4: Facility Information

Have any areas been added or removed from the permit area due to annexation or other legal means?

YES NO

If YES, provide the web address for an online map, below, or check "attached" below and **attach an updated map** labeled as "Part 4" that identifies the jurisdictional boundaries.

Provide the map's web address or indicate if a map is attached (if applicable): Attached

Part 5: Notice of Reliance on Third Party

Is the permittee relying on another entity to satisfy any of the permit obligations (if applicable) that has not been reported to the division in a previous report or permit application (including reports under previous permit terms). YES NO

If YES, **attach a short narrative** labeled as "Part 5" identifying the permit requirement and the entity relied on.



Part 7 - Program Implementation Report

(Part 6 of the report was only applicable to the 2016 report and has been removed)

7.A) Compliance Schedule = required Annual Report Notifications

For all compliance schedule actions completed by January 1 of the year the report is due (including those actions completed prior to the reporting period), identify the date of completion. Refer to Part I.H of the permit.

Only complete those rows for which the deadline was met during the reporting period.

This table reflects all compliance schedule items for the permit term, which includes permit conditions that do not need to be met during the current reporting period.

Permit Condition	Action	Deliverable	Deadline	Date of Completion/Implementation
	County growth area maps (Part I.A.3.a.ii(B)) - Completed January 1, 2017 Refer to Part I.H of the permit, not a required element for reporting in the annual report.			
I.C.1, and PDD content requirements in Parts I.D and E	Complete PDD (contents must reflect terms and conditions that are in effect, i.e., following the associated compliance schedule deadline)	Notification in annual report Due March 10, 2019	Completed January 1, 2019	12/31/2018
I.E.2.a.ii,iii,v I.E.3.c.ii,iii I.E.4.c.ii,iii	Complete all applicable changes to the regulatory mechanism(s): Ensure requirements are met; revise implementation and documentation if necessary.	Notification in annual report Due March 10, 2020	Completed July 1, 2019	6/30/2019
I.E.1.a.i	Illicit Discharges: Begin providing information targeting business(es) and the general public	Notification in annual report Due March 10, 2019	Begin implementation July 1, 2018	7/1/2018
I.E.1.a.ii	Education and Outreach Activities: Begin providing annual public education and outreach from Table 1.	Notification in annual report Due March 10, 2019	Begin implementation January 1, 2018	12/31/2017
I.E.1.a.iii(A)	Nutrients: Determine targeted sources of nutrients.	Notification and list of targeted sources in annual report Due March 10, 2018 Attach List to March 10, 2018 Annual Report following completion, labeled as "PART 7.A - Nutrient Targets"	Completed January 1, 2018	12/31/2017
I.E.1.a.iii(B)	Nutrients: Begin providing education and outreach to the targeted sources	Notification in annual report Due March 10, 2019	Begin implementation July 1, 2018	7/1/2018
I.E.2.a.iv(A) and (B)	Tracing an Illicit Discharge: Ensure requirements are met; revise implementation and documentation if necessary.	Notification in annual report Due March 10, 2018	Completed January 1, 2018	12/31/2017
I.E.2.a.vi	Removing an Illicit Discharge, Enforcement Response: Ensure requirements are met; revise implementation and documentation if necessary.	Notification in annual report Due March 10, 2018	Completed January 1, 2018	12/31/2017
I.E.2.a.viii	Priority Areas: Identify any new priority areas	Notification in annual report Due March 10, 2018	Completed January 1, 2018	12/31/2017
I.E.2.b.vi	Removing and Illicit Discharge: Ensure documentation is recorded.	Notification in annual report Due March 10, 2018	Completed January 1, 2018	12/31/2017
I.E.3.	Begin implementing the permittee's current construction sites program in the county growth areas.	Notification in annual report Due March 10, 2020	Completed January 1, 2019	N/A
I.E.3.c.i	Excluded Activities for County Growth Areas: Ensure requirements are met; revise implementation and documentation if necessary.	Notification in annual report Due March 10, 2020	Completed July 1, 2019	N/A



7.A) CONTINUED: Compliance Schedule = required Annual Report Notifications

Permit Condition	Action	Deliverable	Deadline	Date of Completion/Implementation
I.E.3.c.iv	Control Measure Requirements: Ensure control measure requirements are met; revise implementation and documentation if necessary.	Notification in annual report Due March 10, 2020	Completed July 1, 2019	6/30/2019
I.E.3.c.v(B) through (C)	Site Plans: Ensure requirements are met; revise implementation and documentation if necessary.	Notification in annual report Due March 10, 2020	Completed July 1, 2019	6/30/2019
I.E.3.c.vi(B) through (E)	Site Inspection: Ensure requirements are met; revise implementation and documentation if necessary.	Notification in annual report Due March 10, 2020	Completed July 1, 2019	6/30/2019
I.E.3.c.vii(B)	Enforcement Response: Ensure requirements are met; revise implementation and documentation if necessary.	Notification in annual report Due March 10, 2020	Completed July 1, 2019	6/30/2019
I.E.3.d.vi	Site Inspection: Ensure requirements are met; revise implementation and documentation if necessary, ensure documentation is recorded.	Notification in annual report Due March 10, 2020	Completed July 1, 2019	6/30/2019
I.E.4.	Begin implementing the permittee's current post- construction sites program in the county growth areas.	Notification in annual report Due March 10, 2020	Completed January 1, 2019	N/A
I.E.4.c.i	Excluded Sites: Ensure requirements are met; revise implementation and documentation if necessary.	Notification in annual report Due March 10, 2020	Completed July 1, 2019	6/30/2019
I.E.4.c.iv	Control Measure Requirements: Ensure new control measures meet one of the design standards	Notification in annual report Due March 10, 2020	Completed July 1, 2019	6/30/2019
I.E.4.c.v	Site Plans: Ensure requirements are met; revise implementation and documentation if necessary.	Notification in annual report Due March 10, 2020	Completed July 1, 2019	6/30/2019
I.E.4.c.vi and vii	Construction Inspection and Acceptance and Post Acceptance Oversight: Ensure requirements are met; revise implementation and documentation if necessary.	Notification in annual report Due March 10, 2020	Completed July 1, 2019	6/30/2019
I.E.4.c.viii	Enforcement Response: Ensure requirements are met; revise implementation and documentation if necessary.	Notification in annual report Due March 10, 2020	Completed July 1, 2019	6/30/2019
I.E.5.a.ii	Municipal Facility Runoff Control Measures: Ensure requirements are met; revise implementation and documentation if necessary.	Notification in Annual report Due March 10, 2018	Completed July 1, 2017	6/1/2017
I.E.5.a.ii(C)	Municipal Facility Runoff Control Measures: Ensure inspection requirements are met; revise implementation and documentation if necessary.	Notification in annual report Due March 10, 2020	Completed July 1, 2019	6/30/2019
I.E.5.a.iv	Nutrient Source Reductions: Ensure requirements are met; revise implementation and documentation if necessary.	Notification in annual report Due March 10, 2021	Completed July 1, 2020	6/30/2020
I.E.5.a.v.	Outdoor Bulk Storage	Notification in annual report Due March 10, 2022	Completed July 1, 2021	
I.E.5.b.i	Municipal Facility Runoff Control Measures: Ensure documentation is recorded.	Notification in annual report Due March 10, 2020	Completed July 1, 2019	6/30/2019



7.C) Assessment and Modifications

i. The results of the assessment of the effectiveness of the control measures.
 Provide a narrative based on the assessment required in Part I.G.1.b of the Permit. The permit does not identify the scope or scale of information required beyond this information, the permittee may determine the extent and nature of information provided to meet this requirement.

Provide information below, or check “attached” and **attach the information** labeled as “PART 7.C.i”
 Attached

The Town of Parker has reviewed the compliance schedule in part 1.H of this permit and is currently complying with the appropriate measures identified with a compliance date of July 1, 2020 and earlier.

ii. The results of the permit modification assessment and if any parts of this permit need to be modified or a condition of the permit may not be practicable.
 Provide a narrative based on the assessment required in Part I.G.1.c of the Permit. The permit does not identify the scope or scale of information required beyond this information, the permittee may determine the extent and nature of information provided to meet this requirement.

Provide information below, or check “attached” and **attach the information** labeled as “PART 7.C.ii”
 Attached

The Town of Parker does not propose modifications to this permit as all requirements with a compliance date of July 1, 2020 and earlier are being met by practicable means.



7.D) *Program Elements - Public Education and Outreach (Part I.E.1)

*All of 7.D is not required prior to the Jan 1, 2018 deadline for implementing in accordance with I.E.1.a.i, ii, & iii

iii. List of the education and outreach activities completed in accordance with Part I.E.1.a.i. - Illicit Discharges Education and Outreach.

Provide list below.

Site visits to discuss good housekeeping and water quality as well as business brochure.

Website

Newspaper Advertisement

iv. List of the education and outreach activities completed in accordance with Part I.E.1.a.ii. - Education and Outreach Activities Table, referencing the activities in Table 1 of the Permit.

The permittee must implement at least four education and outreach activities (bulleted items) and at least two must be from the Active and Interactive Outreach column. Check those activities conducted in the table below.

Passive Activity

Check all activities implemented during report year

- Bus shelter/bench advertisement
- Billboard/dasher board advertisement
- Vehicle/bus advertisement
- Radio/television/movie theater advertisement
- Newspaper advertisement
- Distribute educational materials by brochure
- Distribute educational materials by fact sheet
- Distribute educational material by utility bill insert
- Publish article (hard copy or electronic)
- Storm drain marking by permittee staff that maintains 25% of permittee maintained inlets.
- Stormwater related signage
- Web site

Active and Interactive Outreach Activity

Check all activities implemented during report year

- Ongoing advertisement/promotion of a stormwater hotline number or other method to report an illicit discharge
- Ongoing advertisement/promotion on how to get more information about the stormwater program
- Ongoing social media program
- Web site that is interactive or contains stormwater information that includes actions that can be taken to reduce stormwater pollution
- Newsletter (hard copy or electronic)
- Promotion of existing local stormwater/environmental events or program that help protect water quality
- Distribute promotional items or giveaways
- Participate in or sponsor a water festival which involves populations that exist within the permit boundary
- Participate in or sponsor a waterway clean-up and trash removal event
- Participate in or sponsor a service project
- Participate in or sponsor a stormwater or environmental presentation
- Participate in or sponsor a stormwater or environmental event
- Participate in or sponsor community project based programs that investigate watershed health and meet applicable school Science, Technology, Engineering and Math (STEM) standards

Continued on Next Page



**Active and Interactive Outreach Activity Column,
Continued**

- Participate in or sponsor a household hazardous waste event
- Participate in or sponsor an Adopt-a-Street program
- Participate in or sponsor an Adopt-a-Waterway program
- Participate in or sponsor an Adopt-a-Storm Drain program
- Provide ongoing access to motor vehicle fluids recycling program
- Stormwater booth at a community event
- Conduct a stormwater survey
- Storm drain marking program performed by the public/community
- Pet waste stations
- Participate in, plan, or present stormwater materials to schools
- Stormwater demonstration projects that show control measures or other pollutant reduction methods

v. A list of the education and outreach activities completed in accordance with Part I.E. 1.a.iii. - nutrients and targeted sources

Provide list below, including the pollutant sources targeted for each activity.

Newspaper Articles in cooperation with Douglas County Cooperative for Local Environmental Awareness and Responsibility (CLEAR). Targeted pollutant sources are nitrogen and phosphorus.

Website with water quality information for residents.



7.E) Program Elements - Illicit Discharge Detection and Elimination	
<p>vi. Provide the total number of <u>unresolved reports/identification of illicit discharges</u>. An unresolved illicit discharge is one that has been identified or reported to the permittee and the requirements for removing the illicit discharge were not met during the reporting period. Refer to requirements for removing an illicit discharge in Part I.E.2.a.vi of the new permit. For the period prior to implementing a program to meet Part I.E.2.a.vi in accordance with the compliance schedule, refer to the permittee’s CDPS Stormwater Management Program Description from the previous permit term.</p>	0

7.F) Program Elements - Construction Sites	
The permittee can define what constitutes an individual “site” and “inspection” for reporting below as appropriate for the permittee’s own program.	
<p>i. Applicable construction sites: Provide the total number of applicable construction sites during the year. “Applicable construction sites” are sites for which “applicable construction activities,” as defined in the permit, occurred during the <u>reporting year</u>.</p>	130
<p>ii. *Routine Inspections: Provide the total number of Routine Inspections performed during the year. Routine Inspections are inspections of applicable construction activities that meet the inspection scope requirements in Part I.E.3.a.vi(C) and for which documentation is recorded in accordance with in Part I.E.3.d.vi.</p> <p>*Not required prior to the July 1, 2019 deadline for documenting in accordance with I.E.3.b.vi.</p>	1,009
<p>iii. *Reduced Site Inspections: Provide the total number of Reduced Site Inspections performed during the year. Reduced Site Inspections are inspections of applicable construction activities that meet the inspection scope requirements in Part I.E.3.c.vi(D)(1), (2), (3) and (4) for which documentation is recorded in accordance with in Part I.E.3.d.vi.</p> <p>*Not required prior to the July 1, 2019 deadline for documenting in accordance with I.E.3.b.vi.</p>	328
<p>iv. *Compliance Inspections: Provide the total number of Compliance Inspections performed during the year. Compliance Inspections are inspections, operator reporting, or other action(s) to assess the control measure has been implemented or corrected of applicable construction activities that meet the inspection scope requirements in Part I.E.3.c.vi(E) and for which documentation is recorded in accordance with in Part I.E.3.d.vi.</p> <p>*Not required prior to the July 1, 2019 deadline for documenting in accordance with I.E.3.b.vi.</p>	222
<p>v. COUNTY PERMITTEES ONLY</p> <p>*County Growth Area Excluded Construction: Where any construction activities excluded from being applicable construction activities in accordance with Part I.E.3.c.i(B) (1) or (2)? <input type="checkbox"/> YES <input type="checkbox"/> NO If YES, attach a list of the excluded construction sites. Include recordkeeping information required by Part I.E.3.d.i. Label the attachment as “Part 7.F.v Excluded Growth Area Construction.”</p> <p>*Not required prior to the January 1, 2019 deadline for implementing in growth areas.</p>	



7.G) Program Elements - Post-Construction Stormwater Management in New Development and Redevelopment Program The permittee can define what constitutes an individual "site" and "control measure" for reporting below as appropriate for the permittee's own program.	
i. Applicable development sites: Provide the total number of applicable development sites for which control measures were implemented during the reporting period	16
ii. *Long-Term Operation and Maintenance and Post Acceptance Oversight: *ii.a and ii.b, below, are not required prior to the July 1, 2019 deadline for conducting inspections in accordance with Part I.E.4.c.vii.	
ii.a Provide the total number of applicable <u>development sites</u> inspected to ensure compliance with the requirement in Part I.E.4.c.vii.	306
ii.b Provide the total number of applicable <u>control measures</u> inspected to ensure compliance with the requirement in Part I.E.4.c.vii.	306
iii. *Excluded Roadway Development Sites: Where any development excluded from being an applicable development site in accordance with the following permit conditions? Pavement Management: Part I.E.4.c.i(A), except maintenance sites <input type="checkbox"/> YES <input checked="" type="checkbox"/> NO Roadway Redevelopment: Part I.E.4.c.i(B) <input type="checkbox"/> YES <input checked="" type="checkbox"/> NO Existing Roadway Areas Part I.E.4.c.i(C) <input type="checkbox"/> YES <input checked="" type="checkbox"/> NO If YES to one or more of the above, attach a list of the excluded development sites, identifying which exclusion applied. Include the recordkeeping information required by I.E.4.d.ii. Label the attachment as "Part 7.G.iii Excluded Roadway Development." *Not required prior to the July 1, 2019 deadline for implementing control measure in accordance with I.E.4.c.iv and exclusion requirements in accordance with I.E.4.c.i	
iv. COUNTY PERMITTEES ONLY *County Growth Area Excluded Development Sites: Where any developments excluded from being applicable development sites in accordance with Part I.E.4.c.i (G)(1)? <input type="checkbox"/> YES <input type="checkbox"/> NO If YES, attach a list of the excluded development sites. Include the recordkeeping information required by I.E.4.c.i (G)(1). Label the attachment as "Part 7.G.iv Excluded Growth Area Development." *Not required prior to the January 1, 2019 deadline for implementing in growth areas.	

Part 8: Required Certification Signature [Reg 61.4(1)(h)] "I certify under penalty of law that this document and all attachments were prepared under my direction or supervision in accordance with a system designed to assure that qualified personnel properly gather and evaluate the information submitted. Based on my inquiry of the person or persons who manage the system, or those persons directly responsible for gathering the information, the information submitted is to the best of my knowledge and belief, true, accurate and complete. I am aware that there are significant penalties for submitting false information, including the possibility of fine and imprisonment for knowing violations."	
Name (Legal Contact): <i>Michelle Kivela</i>	Title: <i>Town Administrator</i>
Signature (Original Ink Signature): 	Date signed: <i>3/8/2021</i>



PART 4:
FACILITY INFORMATION

Town of Parker 2020 Annexations

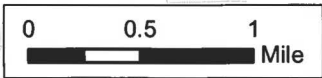
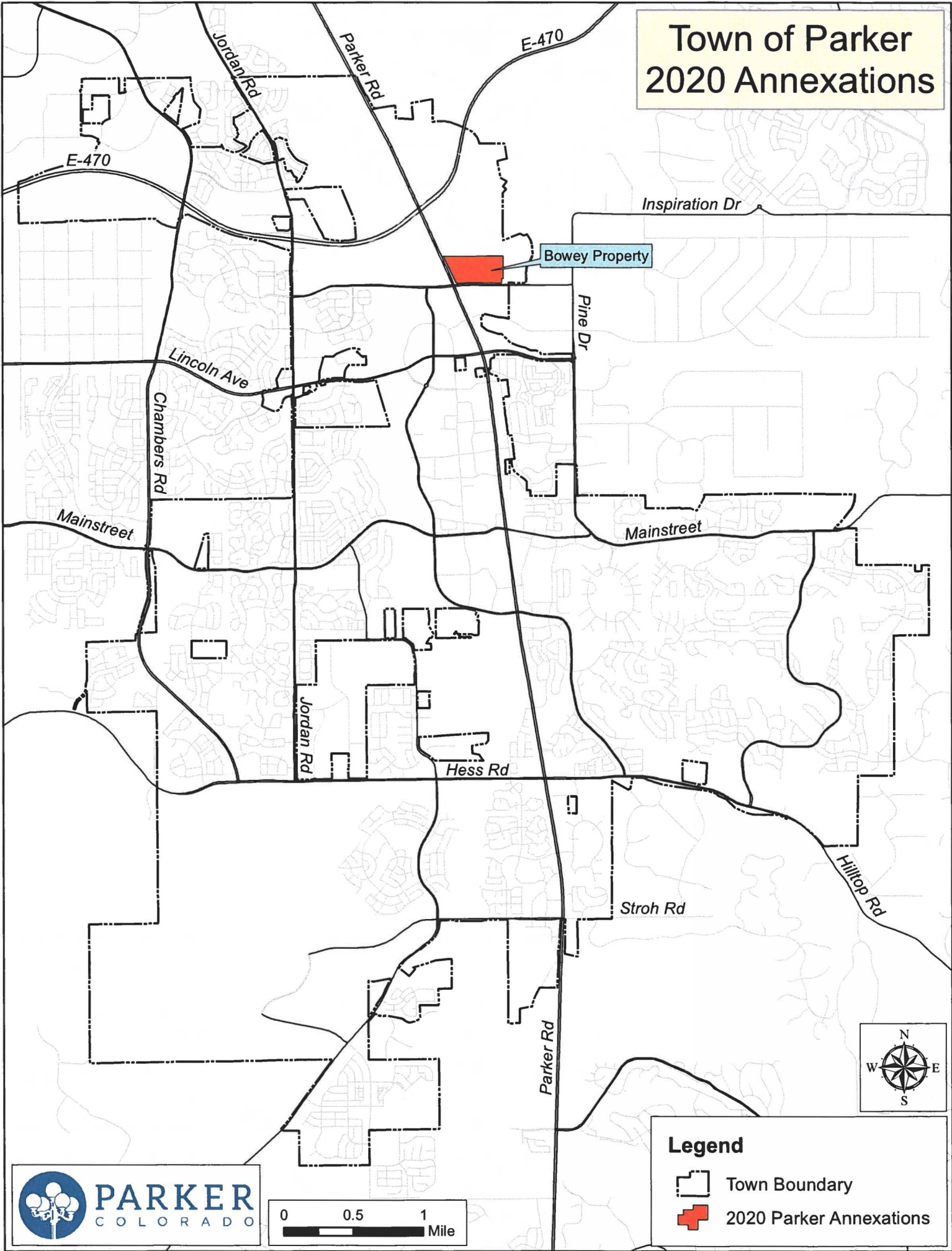

Legend

- Town Boundary
- 2020 Parker Annexations